

Operation Instruction of 1.2GHz 2W Transmitter (TX)

I. Product appearance

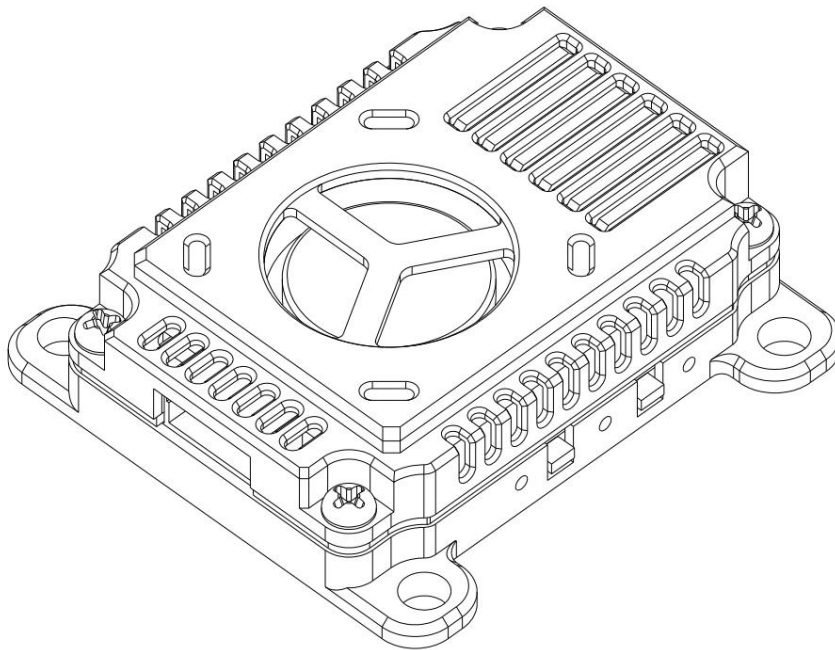

II. Product dimension

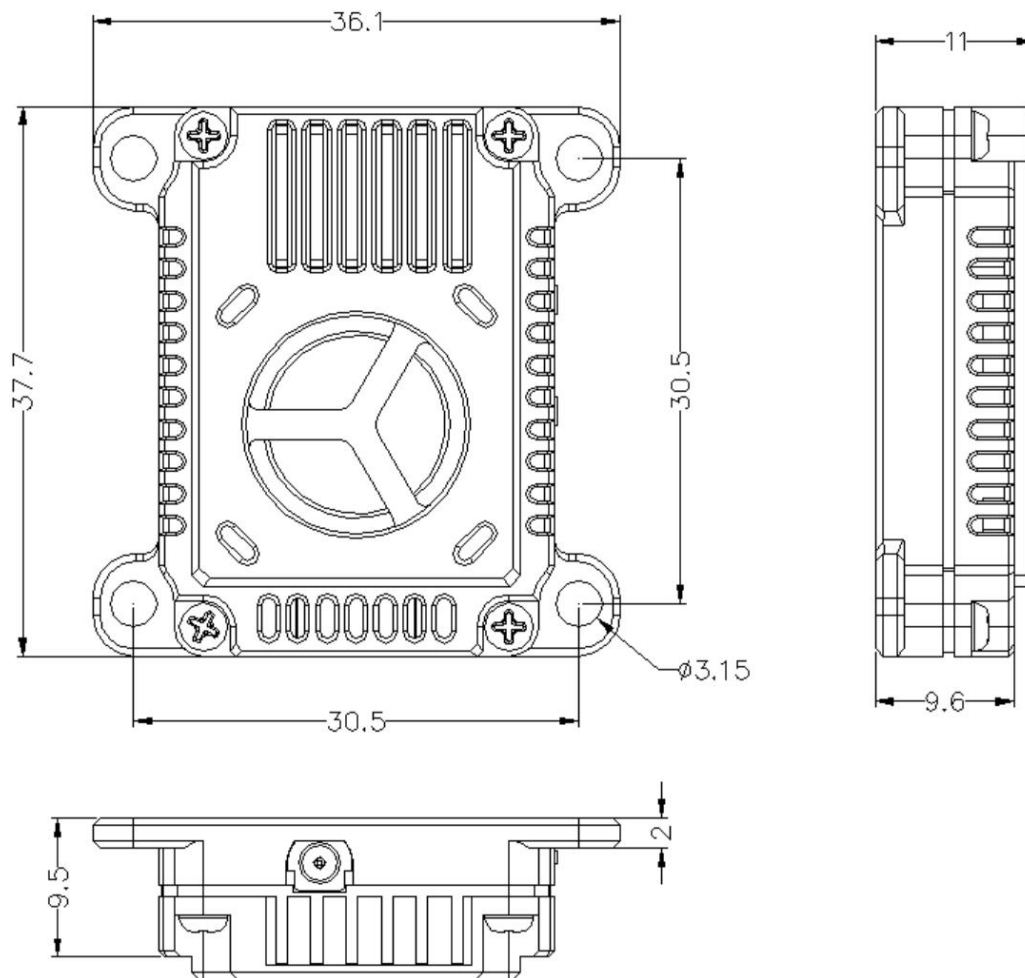

III. Specifications:

1. 9CH 1.2G frequency range: (1060MHz-1380MHz);
2. Max power: 2W (25mW/2000mW, two level adjustable);
3. Input voltage: DC 7V-36V, supporting 2-8S battery input
4. Antenna connector: MMCX
5. Smart audio: IRC Tramp

6. Heat-dissipating method: aluminum alloy heat sink&fan

7. Hole spacing: 30.5mm*30.5mm /ø3.15mm

8. Dimension: 37.7mm*36.1mm*11mm

9. Weight: 16g

IV. Function introduction:

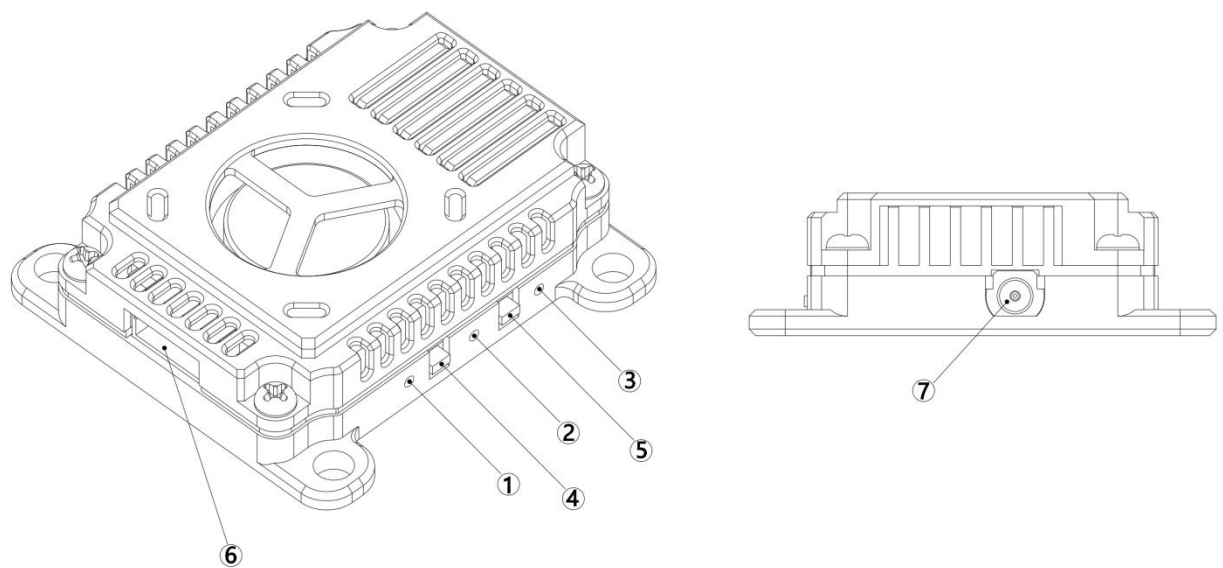

1. Channel indicator: Red LED (1 Band-9Channel)

2. Power indicator: Blue LED (25mW)

3. Power indicator: Green LED (2000mW/Pit mode)

4. Channel changer button

5. Power changer button

6. 1.0 6P Power connector

7. MMCX antenna connector

V. Control method and LED indicator

1. Button ④ is used to switch band and channel; every time when button

④ is pressed for a short time to switch to the next channel, the red LED ① will flash, 1.2.3.4.5.6.7.8.9 in turn. The operation can be cyclic; see the following diagram for details!

Short press button ④ to switch channel									
	CH1	CH2	CH3	CH4	CH5	CH6	CH7	CH8	CH9
Red LED	Flash once	Flash twice	Flash for 3 times	Flash for 4 times	Flash for 5 times	Flash for 6 times	Flash for 7 times	Flash for 8 times	Flash for 9 times

2. Button ⑤ is used to switch RF power; pressed button ⑤ for a short time to switch to the next RF power level, RF power cycling between 25mW, 2000mW. The RF power is 25mW when the blue LED ② is turned on; the RF power is 2000mW when the green LED ③ is turned on; When the button is pressed and held for more than 3 seconds, the Transmitter will enter pit mode. The green LED and blue LED will permanently light up simultaneously. See the following diagram for details!

When the button is pressed and held for more than 3 seconds, the Transmitter will enter pit mode, The blue LED ② and green LED ③ will permanently light up simultaneously. See the following diagram for details!

1. Short press button ⑤ to switch power; 2. Long press the button to enter Pit mode		
25mW	2000mW	Pit mode
Blue LED is turned on	Green LED is turned on	Blue LED and green LED will be turned on simultaneously

VI. Frequency Table

Frequency Table									
Channel	CH 1	CH 2	CH 3	CH 4	CH 5	CH 6	CH 7	CH 8	CH 9
MHz	1080	1120	1160	1200	1240	1280	1320	1360	1258

VII. Illustrate of 6P 1.0 Wiring

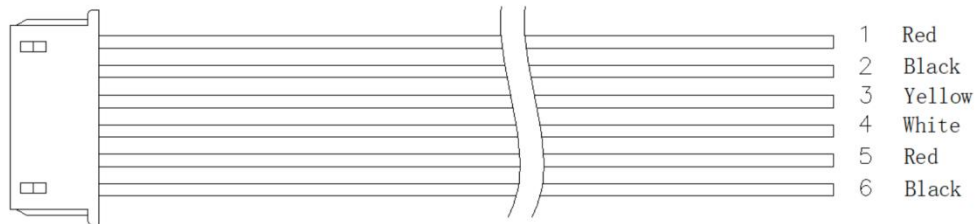

Wiring Table:

NO	1	2	3	4	5	6
FUN	7-36V	GND	Video	IRC	5VOut	GND
Color	Red	Black	Yellow	White	Red	Black

VIII. Notice for Use:

1. A certain space shall be reserved when the transmitter is installed to ensure the air convection around the module and module cooling; otherwise, if the overheating protection of the module is started, the power emission will be lowered and even closed.
2. We suggested to ensure correct voltage scope and correct positive and negative anodes before powering-on to avoid element burning-out.
3. We suggested to confirm antenna has been installed at the RF output terminal before powering-on to extend the service life of transmitter.
4. Please read the Instruction before use to ensure correct wiring and extend the service life of transmitter.

IX. Packing list:

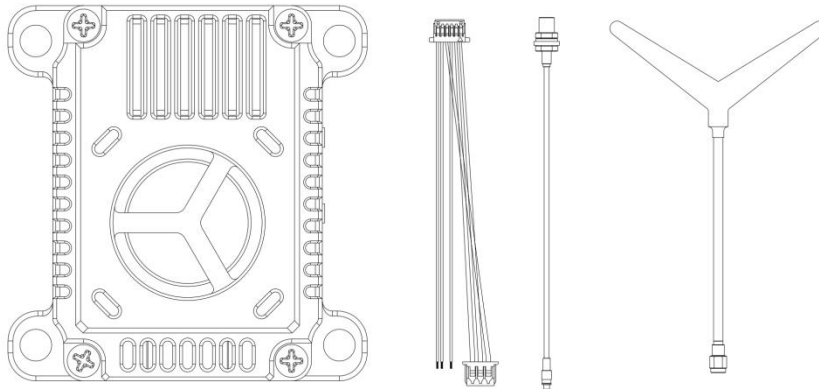

1. 1 * 1.2GHz VTX

2. 1 * MMCX interface antenna connection cable

3. 1 * 6P 1.0 connecting wiring

4. 1 *1.2G Y-type special antenna